

19,305



Oncor Electric Delivery
Jason Conover
Designer
3873 Hwy 69N
Greenville, TX 75401

February 4, 2025

Office of County Commissioners
PO Box 1097 Greenville, TX 75403

FILED FOR RECORD
at 1:00 o'clock P M

FEB 11 2025

RE: Overhead Distribution Line Installation CR 1003 WO 26464754

BECKY LANDRUM
County Clerk, Hunt County, Tex.

By

Greetings,

Oncor Electric Delivery LLC., is requesting permission to do work within the county right of way along CR 1003, 291' East of the Driveway to 1112 CR 1003. We are looking to install a single phase OH distribution line 45' across CR 1003 and install a Pole approximately 1' inside the Southern ROW of CR 1003. Site location map and permit exhibit are enclosed. The permit exhibit details the proposed work. If you have any questions, please contact at any time.

Sincerely,

Jason Conover
Designer

#11

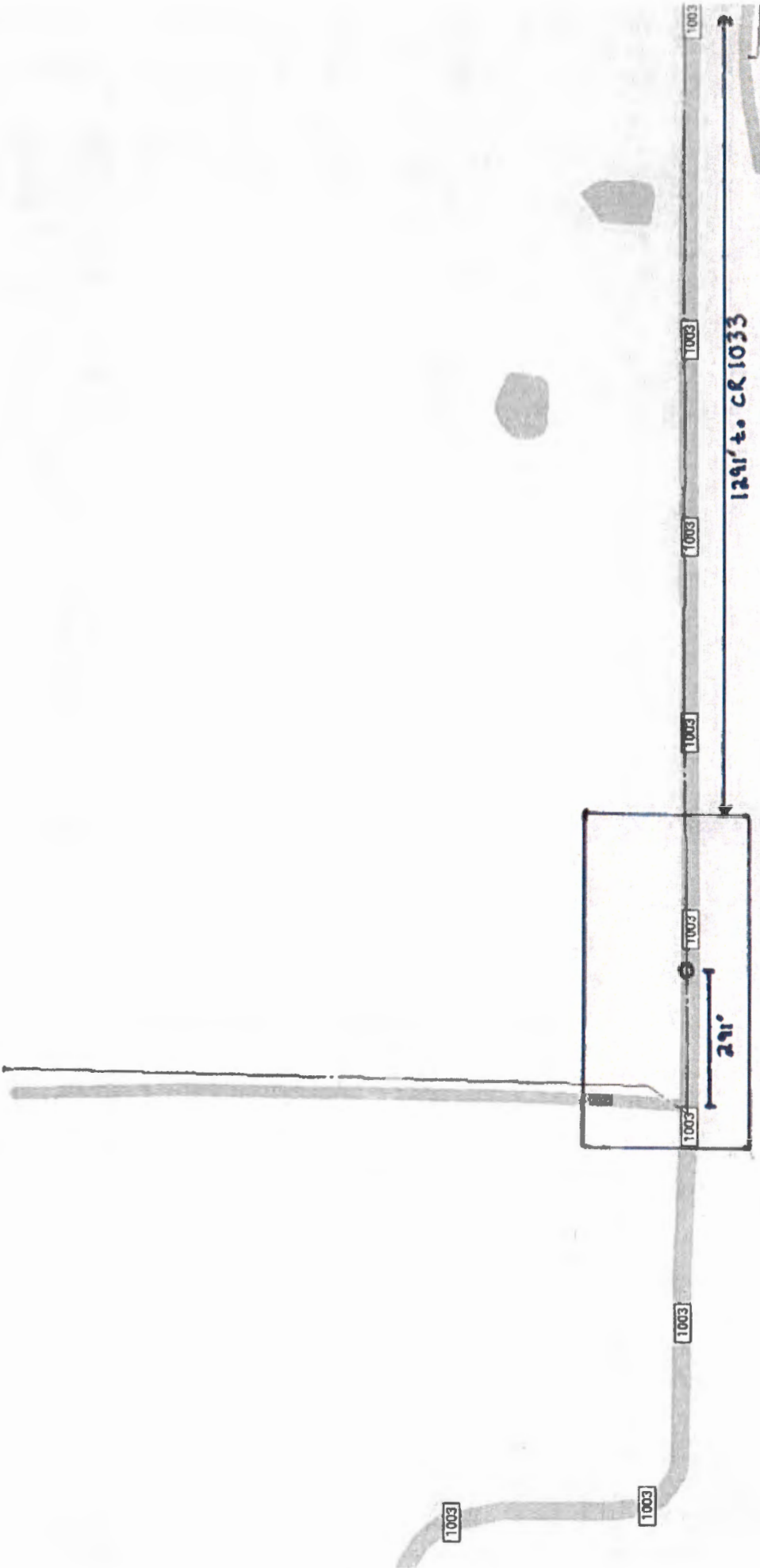

ELECTRIC CONSTRUCTION PRINT

WD Number: **26464754-01** Date: **2025/01/30** Description: **Blake Lasky - 1112 County Road 1003, Greenville 75401**
Sheet **1** of Scale: **1"=30'** Customer:
Job Status: **Design** Svc Ctr / Office: **CEL/** Address: **It will be across 1003 from 1112 CR 1003 Greenville, TX GREENVILLE**
Designer: **CONOVER, STEVEN J/MSJK** 903-458-0725 Location:
Project Mgr: **CONOVER, STEVEN J/** 903-458-0725

Copyright 2008 Clear Electric Delivery. Mass, drawings, and electronic data (products) are created for the internal purposes of Clear Electric Delivery with no implication of liability or fitness for the intended use of the recipient. Clear Electric Delivery will make good faith efforts to provide products that are free from error, but does not warrant the accuracy or quality of any products. The locations shown are approximate and are not intended to show exact numbers. Products provided by other parties by Clear Electric Delivery are for the internal use of the recipient, and the recipient agrees not to duplicate or distribute the products or any portion of the products to third parties without the prior written permission of Clear Electric Delivery. The recipient further agrees to hold harmless and indemnify Clear Electric Delivery against all claims, costs, expenses and damages resulting from or produced upon strict liability for personal injuries, death or property damage, on account of any defect in the property provided hereunder.



R: 40'3 WP
I: 40'3 WP

1

3322994
-09613158

I: 37 A

4 ACSR (Phase A) (24.9)
CLSTE2101

3322982
-09613158

*Install
Pole 1' inside CR1003 ROW*

I: [310806 X]
I: 40'3 WP

2

UPD: 418977
Primary Fuse
FLN: 1860307 - 6702824

